

# Blackstone Metro District -2021-2022 Snow Plan

**Common District Areas:** Blackstone Metropolitan District areas (which include sidewalks through the medians, mailbox kiosks, park sidewalks, and the perimeter community sidewalks) will be cleared of snow once the 2" accumulation trigger has been met.

- Snow removal operations will begin once the storm has finished, and if the snow accumulation reached the 2" trigger.
- The interior is completed first, then the exterior, and the mailbox kiosks are completed last.
- The snow removal will be completed using an ATV, truck with plows, and hand shoveled where needed.

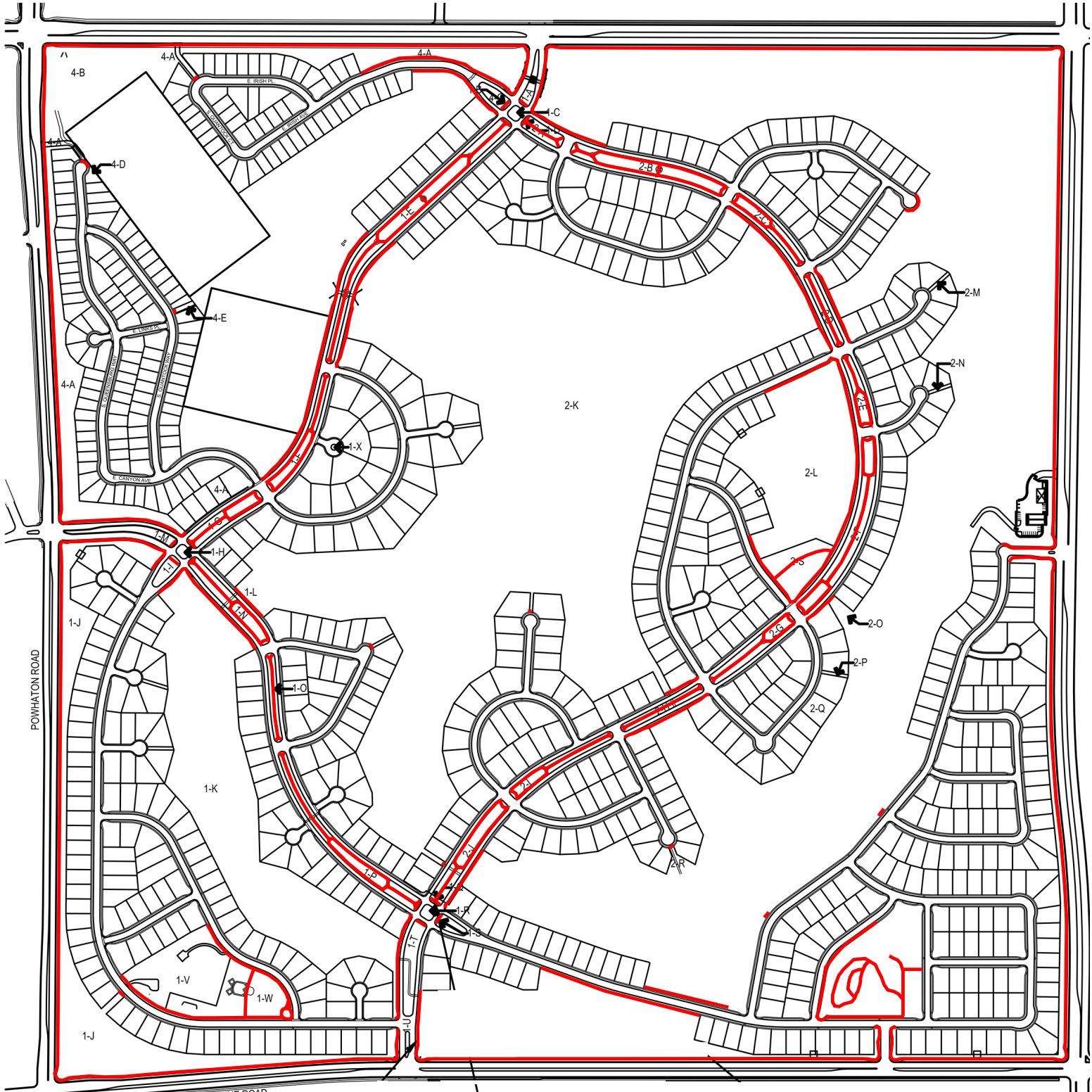

**City of Aurora Streets:** Snow Plowing on City Streets is completed and permitted only under a special agreement with the city. Once a snow accumulation of 6" or more has been met, the District's Contractor (Landtech) will perform snow plowing of the roads shown in BLUE, otherwise, the City will perform snow services in accordance with its normal snow routes / standards on the RED lined areas below.

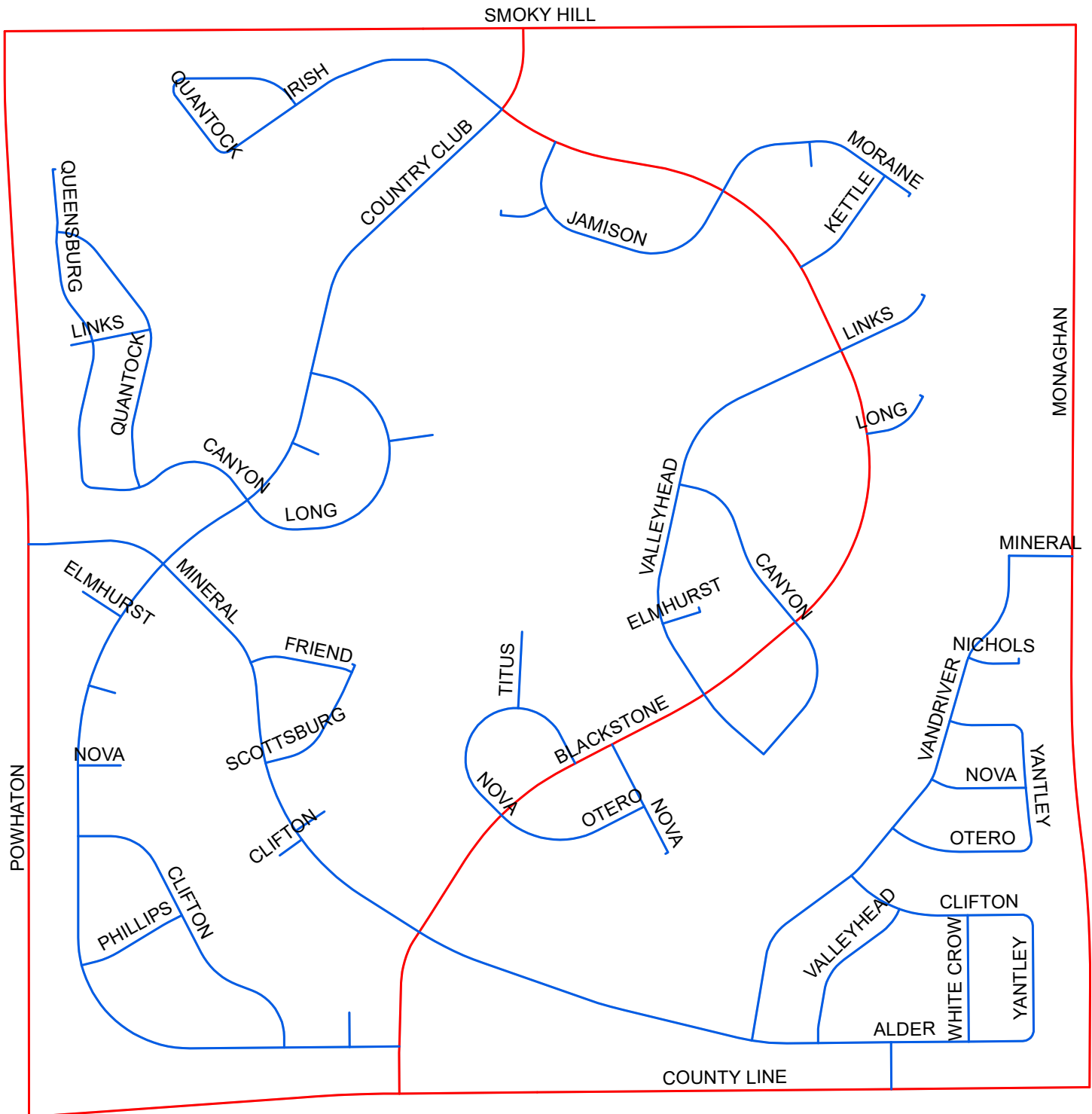

## Legend

- Blackstone Snow Removal Routes
- City of Aurora Snow Removal Routes